



Meetings And Events

Hilton London Metropole hotel

225 Edgware Road, London, W2 1JU, United Kingdom

Tel: +(44)02074024141

International sales office

Tel: +44 (0) 207 856 8202

Conference & Events

cbs.londonmet@hilton.com



[FIND OUT MORE](#)

[SUBMIT ENQUIRY](#)

Just 10 minutes' walk from the West End and Oxford Street and a 10 minute tube ride from Westfield Shopping Centre, the Hilton London Metropole hotel is the ideal destination for the business and leisure guest. Take a stroll to Hyde Park or relax in the gym, pool or sauna. Dine on international cuisine at Fiamma Restaurant or sample Asian Fusion favourites at Minako at the Met. Take in London attractions like The Tower of London and the London Eye. Spend the evening watching Shakespeare at The Globe or enjoy concerts and sports events at Wembley Stadium, just a 30-minute train ride away from the District Line station opposite the hotel. All Hilton London Metropole hotel rooms offer high-speed wireless internet access. Choose an Executive Room or one of our Suites for complimentary Executive Lounge access. Wireless internet access is available in all public areas of the hotel.



Location

Travel to the Hilton London Metropole hotel in the heart of central London, just a 10-minute walk from Oxford Street. This major conference hotel is 20 minutes from Heathrow Airport. The Heathrow Express terminates at Paddington Station, which is just 5 minutes by taxi from the hotel. The nearest underground station is Edgware Road (2 stations - 1 station for Circle, District and Hammersmith & City Lines and 1 station for Bakerloo line, both directly opposite the hotel). The Hilton London Metropole is located outside of London's Congestion Zone and boasts a secure car park with 170 spaces.

At a glance

15 minutes from Heathrow, the Hilton London Metropole hotel is a premier conference venue offering 41 events and meeting rooms, including 2 suites, with the capacity for up to 1600 delegates.

Meetings Facilities:

- 41 Meeting Rooms
- Largest Room 1062.0m²
- 1054 Guest Rooms
- 20 Suites

Hotel Features:

- Wireless in all public areas
- Wireless in all meeting rooms
- Executive Floor
- Business Centre

Hilton Meetings

Hilton Meetings sets the industry standard for small meetings and offers consistently excellent levels of service, equipment and facilities around the globe. Easy to book, easy to use, Hilton Meetings is your guarantee of high-quality meeting rooms and impeccable business-focused services.



Meetings And Events

Room configuration



East Wing - 2nd Lower Floor



	Total sq. m	Room size	Ceiling Ht.	Maximum number of people per seating style						
				Classroom	Theatre	Banquet	Reception	Boardroom	U-Shape	H-Shape
York	169.0	14.04m x 12.04m	2.47m	60	130	150	0	40	40	0
The Windsor Suite	244.7	22.0m x 12.04m	8.1m	120	250	200	0	55	55	0
Lancaster	67.15	9.9m x 7.9m	2.47m	25	60	40	0	15	15	0

East Wing - 3rd Lower Ground



	Total sq. m	Room size	Ceiling Ht.	Maximum number of people per seating style						
				Classroom	Theatre	Banquet	Reception	Boardroom	U-Shape	H-Shape
Kensington	113.1	21.74m x 5.2m	2.9m	0	85	0	0	0	0	0
Buckingham	285.0	19.8m x 14.4m	4.3m	200	350	240	0	0	0	0
Blenheim	321.6	21.75m x 16.7m	4.3m	160	320	240	0	0	0	0
Palace Suite	719.8	36.6m x 21.74m	4.3m	500	800	600	0	0	0	0

East Wing - Mezzanine Level



	Total sq. m	Room size	Ceiling Ht.	Maximum number of people per seating style						
				Classroom	Theatre	Banquet	Reception	Boardroom	U-Shape	H-Shape
View floorplan										
St. James	625.0	10.25m x 5.77m	2.4m	20	50	40	0	20	20	0
Cadogen	518.0	7.1m x 6.78m	2.4m	15	40	30	0	20	20	0
Waterloo	28.2	8.4m x 3.36m	2.1m	0	25	14	0	14	14	0
The Richmond Room	28.8	8.4m x 3.43m	2.1m	0	25	14	0	14	14	0
Berkeley	70.9	10.25m x 7.03m	2.4m	15	40	30	0	20	20	0
Chelsea	29.7	8.4m x 3.54m	2.1m	0	25	14	0	14	14	0
Thames Suite	118.0	14.05m x 8.4m	2.1m	60	120	90	0	30	30	0
Westminster Suite	146.5	21.75m x 6.78m	2.4m	70	135	120	0	0	0	0
Belgrave	49.77	7.56m x 6.78m	2.4m	15	40	30	0	20	20	0
Clarence Room	49.0	8.45m x 6.98m	2.4m	20	50	40	0	20	20	0
Regent's	763.0	10.25m x 7.03m	2.4m	40	70	60	0	25	25	0
Tower	29.7	8.4m x 3.54m	2.1m	0	25	14	0	14	14	0
Park Suite	70.9	10.25m x 7.03m	2.4m	80	130	120	0	40	40	0

Tower Wing - 1st Floor



	Total sq. m	Room size	Ceiling Ht.	Maximum number of people per seating style						
				Classroom	Theatre	Banquet	Reception	Boardroom	U-Shape	H-Shape
Boardroom 2	44.5	8.96m x 5.07m	2.04m	0	0	0	0	16	16	0
Boardroom 1	44.5	8.96m x 5.07m	2.04m	0	0	0	0	16	16	0
Boardroom 3	47.6	9.58m x 5.07m	2.2m	0	0	0	0	16	16	0

Tower Wing - 3rd Floor



	Total sq. m	Room size	Ceiling Ht.	Maximum number of people per seating style						
				Classroom	Theatre	Banquet	Reception	Boardroom	U-Shape	H-Shape
View floorplan										



Meetings And Events

				Room configuration						
Hilton Meeting Room 13	23.9	6.7m x 5.2m	2.9m	0	20	0	0	12	0	0
Hilton Meeting Room 7	21.5	6.7m x 3.4m	2.9m	0	20	0	0	12	0	0
Meeting Room 6	30.0	6.4m x 4.7m	3.1m	15	25	0	0	16	12	0
Hilton Meeting Room 10	20.6	6.7m x 3.4m	2.9m	0	20	0	0	12	0	0
Hilton Meeting Rooms 7+8 / 9+10 / 11+12	42.3	6.8m x 6.7m	2.9m	12	25	0	0	18	10	0
Hilton Meeting Room 15	21.2	6.7m x 3.4m	2.9m	0	20	0	0	12	0	0
Hilton Meeting Room 2	30.0	6.3m x 4.7m	3.1m	15	25	0	0	16	12	0
Hilton Meeting Room 5	30.0	6.4m x 4.7m	3.1m	15	25	0	0	16	12	0
Hilton Meeting Room 14	20.6	6.7m x 3.4m	2.9m	0	20	0	0	12	0	0
Hilton meeting Room 17	14.8	6.7m x 3.4m	2.9m	0	20	0	0	12	0	0
Hilton Meeting Rooms 13+14 / 15+16 / 16+17	42.3	6.8m x 6.7m	2.9m	12	25	0	0	18	10	0
Hilton Meeting Room 8	22.1	6.7m x 3.4m	2.9m	0	20	0	0	12	0	0
Hilton Meeting Rooms 13-15 / 15-17	67.2	10.2m x 6.7m	2.9m	16	34	0	0	24	12	0
Hilton Meeting Rooms 1+2 / 3+4 / 5+6	61.7	9.8m x 6.4m	3.1m	35	50	0	0	32	30	0
Hilton Meeting Room 3	30.0	6.3m x 4.7m	3.1m	15	25	0	0	16	12	0
Hilton Meeting Rooms 7-9 / 10-12	62.7	10.2m x 6.7m	2.9m	16	34	0	0	24	12	0
Hilton Meeting Rooms 1-4 / 3-6	124.6	12.8m x 9.8m	3.1m	65	120	0	0	44	42	0
Hilton Meeting Room 11	21.2	6.7m x 3.4m	2.9m	0	20	0	0	12	0	0
Hilton meeting Room 4	30.0	6.3m x 4.7m	3.1m	15	25	0	0	16	12	0
Hilton Meeting Rooms 13 to 17	101.1	18.8m x 6.7m	2.9m	40	60	0	0	0	0	0
Hilton Meeting Room 16	14.8	6.7m x 3.4m	2.9m	0	20	0	0	12	0	0
Hilton Meeting Room 9	21.2	6.7m x 3.4m	2.9m	0	20	0	0	12	0	0
Hilton Meeting Room 6	30.0	6.4m x 4.7m	3.1m	15	25	0	0	16	12	0
Hilton Meeting Room 1	30.0	6.3m x 4.7m	3.1m	15	25	0	0	16	12	0
Hilton Meetings Rooms 1 to 6	188.0	19.3m x 9.8m	3.1m	120	200	0	0	0	50	0
Hilton Meeting Room 12	20.9	2.9m x 3.4m	2.9m	0	20	0	0	12	0	0

West Wing - 1st Floor



Total sq. m



Room size



Ceiling Ht.

Maximum number of people per seating style

				Classroom	Theatre	Banquet	Reception	Boardroom	U-Shape	H-Shape
Sovereign 1	638.0	32.8m x 23.7m	4.48m	320	650	470	0	0	0	0
Viscount 2	422.0	21.2m x 23.7m	4.48m	150	400	420	0	0	0	0
Viscount 1	332.0	13.9m x 23.7m	4.48m	0	200	200	0	0	0	0
Sovereign 2	810.0	40.0m x 23.7m	4.48m	390	800	650	0	0	0	0
Monarch Suite	1062.0	54.0m x 23.7m	4.48m	600	1600	1000	0	0	0	0



Meetings And Events

Room configuration



West Wing - 3rd Floor



Total sq. m



Room size



Ceiling Ht.

Maximum number of people per seating style

	Total sq. m	Room size	Ceiling Ht.	Classroom	Theatre	Banquet	Reception	Boardroom	U-Shape	H-Shape
Hilton Meetings Rooms 7 to 12	126.0	20.4m x 6.7m	2.9m	60	80	0	0	0	0	0
Balmoral 2	422.0	21.2m x 23.7m	4.48m	150	400	420	0	0	0	0
Balmoral 1	332.0	13.9m x 23.7m	4.48m	0	200	200	0	0	0	0
Sandringham 2	810.0	40.0m x 23.7m	4.48m	390	800	650	0	0	0	0
Sandringham 1	638.0	32.8m x 23.7m	4.48m	320	650	470	0	0	0	0
King's Suite	1062.0	54.0m x 23.7m	4.48m	650	1600	1000	0	0	0	0

Conference & Events

Hilton brings a wealth of experience in creating and delivering exceptional events. With our dedicated event expertise and award-winning services, we'll support you from the planning stage to the event day. Whatever the occasion, we'll make sure your event is successful, memorable and hassle free.

Hilton Executive Floor

Complete with outstanding facilities and dedicated service, Hilton Executive Floors have been created specifically in response to your needs. As well as spacious, well equipped executive bedrooms, they incorporate an Executive Lounge, complimentary breakfast, snacks and beverages, and a range of amenities to help you unwind, prepare or entertain in style.

Connectivity at Hilton

Enjoy the freedom to choose when and where you want to work online. Whether catching up with emails in the comfort of your guest room or counting on secure, reliable connectivity for your meetings and conferences, we provide you with everything you need to stay connected.



Meetings And Events

The Windsor Suite

The Windsor Suite is located in the East Wing just above the Palace Suite. Recently re-designed this lovely room is ideal setting for pre-dinner drinks or breakout sessions alongside the Palace Suite. With space for up to 300 guests buffet style or 250 delegates theatre style, this is a great venue for any event. This room divides into two rooms, the York and Lancaster suites.

Overview

Maximum capacity: 300

Dimensions

22.0m x 12.04m x 8.1m
72.18ft x 39.5ft x 26.57ft

Access size

2.44m x 1.62m / 8.01ft x 5.31ft (WxH)

Area

244.7m²
2632.97m²

Lighting

Dimmer lighting, blackout facilities and crystal chandeliers.

Located on





East Wing - 2nd Lower Floor

Optional equipment

Back Projection
Flip Charts
LCD
Microphone
Overhead Projector
Podium
Projector
Screen
Slide Projector
TV
Video Player



Layout and number of people

-  Classroom - 120
-  U-Shape - 55
-  Theatre - 250
-  Banquet - 200
-  Boardroom - 55



Meetings And Events

Palace Suite

Recently redesigned and refurbished, the Palace Suite has new carpets and is beautifully re-decorated, all of which creates the ideal ambience for any audience. This room features beautiful chandeliers and is the perfect venue for conference or banqueting events. Located in the East Wing of the hotel, this suite can be split into two or three rooms for concurrent sessions or used complete. Breakouts for the same event can be held in the mezzanine meeting rooms on the First Floor.

Overview

Maximum capacity: 800

Dimensions

36.6m x 21.74m x 4.3m
120.08ft x 71.33ft x 14.11ft

Access size

2.06m x 2.06m / 6.76ft x 6.76ft (WxH)

Area

719.8m²
7745.05m²

Lighting

Dimmer lighting, crystal chandeliers and blackout facilities.

Located on

East Wing - 3rd Lower Ground

Optional equipment

- Back Projection
- Flip Charts
- Karaoke
- LCD
- Microphone
- Overhead Projector
- Podium
- Projector
- Screen
- Slide Projector
- TV
- Video Player
- Wireless Internet Access

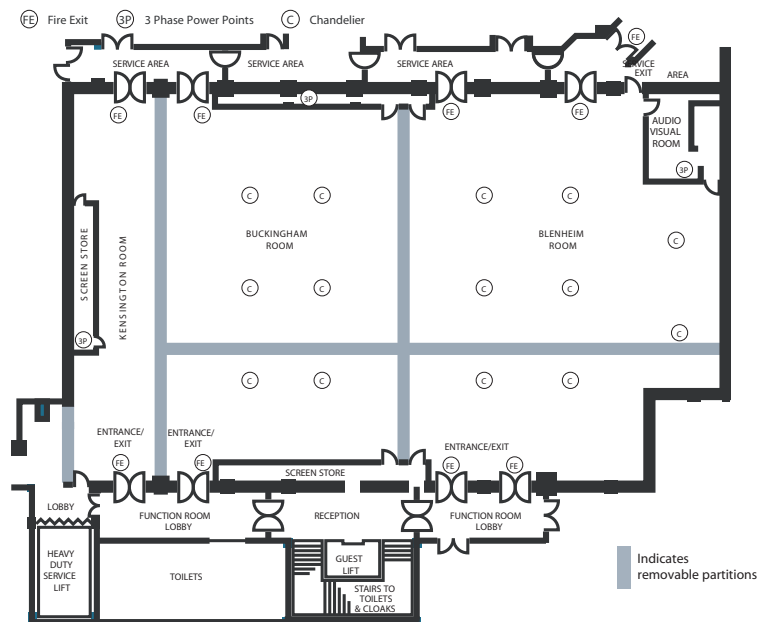

Layout and number of people



Classroom - 500



Theatre - 800



Banquet - 600



Meetings And Events

East Wing - Mezzanine Level

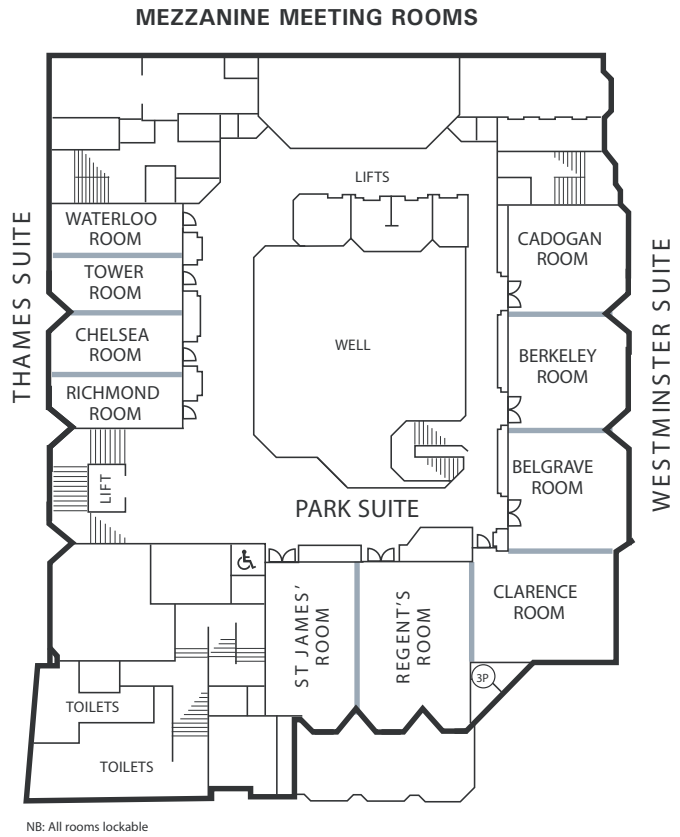
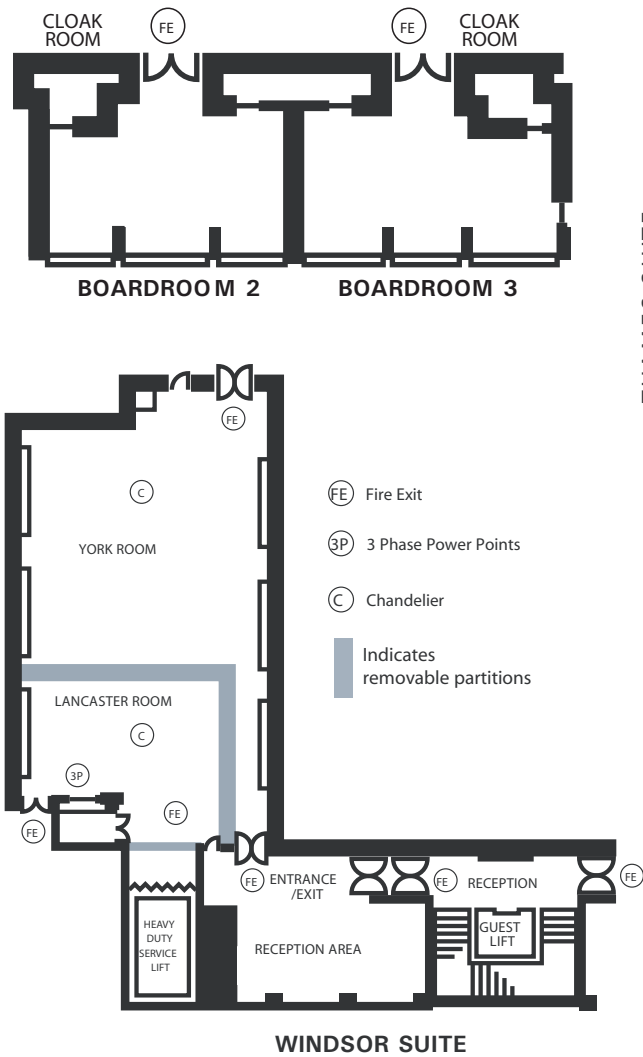



Meetings And Events

Thames Suite

Overlooking the hotel's main lobby and bar, and with natural daylight streaming in to every one of its ten meeting rooms, the Mezzanine Meeting area is a relaxing location to catch breath and clear the head between sessions. It is very popular for breakouts, coffee breaks, hospitality suites and as a registration area for conferences held in the East Wing. Rooms can be connected to form three separate suites, or the whole space can be opened up to cater for receptions of up to 500 delegates.

Overview

Maximum capacity: 120

Dimensions

14.05m x 8.4m x 2.1m
46.1ft x 27.56ft x 6.89ft

Access size

2.0m x 0.76m / 6.56ft x 2.49ft (WxH)

Area

118.0m²
1269.68m²

Lighting

Dimmer lighting, natural daylight and blackout facilities.

Located on



East Wing - Mezzanine Level

Optional equipment

Back Projection
Flip Charts
LCD
Microphone
Overhead Projector
Projector
Screen
Slide Projector
TV
Video Player
Wireless Internet Access



Layout and number of people

-  Classroom - 60
-  U-Shape - 30
-  Theatre - 120
-  Banquet - 90
-  Boardroom - 30



Meetings And Events

Westminster Suite

The Westminster Suite is located on the mezzanine level overlooking the hotels main lobby. The suite is fully accessible and positioned on a shared wide balcony which is ideal for coffee breaks and light catering. All rooms and suites found on the mezzanine level benefit from natural daylight. However, not all the suites are as impressive as the Westminster. The traditional decor of the room is complimented with crystal chandelier lighting.

Overview

Maximum capacity: 200

Dimensions

21.75m x 6.78m x 2.4m
71.36ft x 22.24ft x 7.87ft

Access size

2.0m x 1.37m / 6.56ft x 4.49ft (WxH)

Area

146.5m²
1576.34m²

Lighting

Dimmer lighting, crystal chandeliers, natural daylight and blackout facilities.

Located on

East Wing - Mezzanine Level

Optional equipment

Back Projection
Flip Charts
LCD
Microphone
Overhead Projector
Podium
Projector
Screen
Slide Projector
TV



Layout and number of people



Classroom - 70



Theatre - 135



Banquet - 120



Meetings And Events

Clarence Room

Overlooking the hotel's main lobby and bar, and with natural daylight streaming in to every one of its ten meeting rooms, the Mezzanine Meeting Rooms have recently been refurbished with new carpets, wall coverings and drapes. These 10 rooms are popular for breakout sessions, coffee breaks, hospitality suites and as a registration area for conferences held in the East Wing.

Overview

Maximum capacity: 50

Dimensions

8.45m x 6.98m x 2.4m
27.72ft x 22.9ft x 7.87ft

Access size

2.0m x 0.79m / 6.56ft x 2.59ft (WxH)

Area

49.0m²
527.24m²

Lighting

Dimmer lighting, halogen downlighters, natural daylight and blackout facilities.

Located on

East Wing - Mezzanine Level

Optional equipment

Back Projection
Flip Charts
LCD
Microphone
Overhead Projector
Projector
Screen
Slide Projector
TV
Video Player
Wireless Internet Access



Layout and number of people

-  Classroom - 20
-  U-Shape - 20
-  Theatre - 50
-  Banquet - 40
-  Boardroom - 20



Meetings And Events

Park Suite

Overlooking the hotel's main lobby and bar, and with natural daylight streaming in to every one of its ten meeting rooms, the Mezzanine Meeting Rooms have recently been refurbished with new carpets, wall coverings and drapes. These 10 rooms are popular for breakout sessions, coffee breaks, hospitality suites and as a registration area for conferences held in the East Wing.

Overview

Maximum capacity: 160

Dimensions

10.25m x 7.03m x 2.4m
33.63ft x 23.06ft x 7.87ft

Access size

2.0m x 1.37m / 6.56ft x 4.49ft (WxH)

Area

70.9m²
762.88m²

Lighting

Dimmer lighting, crystal chandeliers, natural daylight and blackout facilities.

Located on





East Wing - Mezzanine Level

Optional equipment

- Back Projection
- Flip Charts
- LCD
- Microphone
- Overhead Projector
- Projector
- Screen
- Slide Projector
- TV
- Video Player
- Wireless Internet Access



Layout and number of people

-  Classroom - 80
-  U-Shape - 40
-  Theatre - 130
-  Banquet - 120
-  Boardroom - 40



Meetings And Events

Boardroom 2

Three purpose designed boardrooms which can accommodate up to 16 executives. They are conveniently located on the first floor of the Tower Wing and are fully accessible. The rooms are spacious, light and modern and feature an array of technical facilities. Air conditioning, versatile lighting and 3 phase power are discreetly integrated into the room in order to help you stage a successful meeting. With ergonomically designed boardroom furnishings, you are sure to have a comfortable and hassle-free stay with us.

Overview

Maximum capacity: 25

Dimensions

8.96m x 5.07m x 2.04m
29.4ft x 16.63ft x 6.69ft

Access size

2.0m x 1.98m / 6.56ft x 6.5ft (WxH)

Area

44.5m²
478.82m²

Lighting

Dimmer lighting, halogen downlighters and blackout facilities.

Located on

Tower Wing - 1st Floor



Layout and number of people

 U-Shape - 16

 Boardroom - 16



Meetings And Events

Boardroom 1

Three purpose designed boardrooms which can accommodate up to 16 executives. They are conveniently located on the first floor of the Tower Wing and are fully accessible. The rooms are spacious, light and modern and feature an array of technical facilities. Air conditioning, versatile lighting and 3 phase power are discreetly integrated into the room in order to help you stage a successful meeting. With ergonomically designed boardroom furnishings, you are sure to have a comfortable and hassle-free stay with us.

Overview

Maximum capacity: 25

Dimensions

8.96m x 5.07m x 2.04m
29.4ft x 16.63ft x 6.69ft

Access size

2.0m x 1.98m / 6.56ft x 6.5ft (WxH)

Area

44.5m²
478.82m²

Lighting

Dimmer lighting, halogen downlighters and blackout facilities.

Located on

Tower Wing - 1st Floor



Layout and number of people

 U-Shape - 16

 Boardroom - 16



Meetings And Events

Boardroom 3

Three purpose designed boardrooms which can accommodate up to 16 executives. They are conveniently located on the first floor of the Tower Wing and are fully accessible. The rooms are spacious, light and modern and feature an array of technical facilities. Air conditioning, versatile lighting and 3 phase power are discreetly integrated into the room in order to help you stage a successful meeting. With ergonomically designed boardroom furnishings, you are sure to have a comfortable and hassle-free stay with us.

Overview

Maximum capacity: 25

Dimensions

9.58m x 5.07m x 2.2m
31.43ft x 16.63ft x 7.22ft

Access size

2.0m x 1.98m / 6.56ft x 6.5ft (WxH)

Area

47.6m²
512.18m²

Lighting

Dimmer lighting, halogen downlighters, natural daylight and blackout facilities.

Located on

Tower Wing - 1st Floor



Layout and number of people

 U-Shape - 16

 Boardroom - 16



Meetings And Events

Tower Wing - 3rd Floor

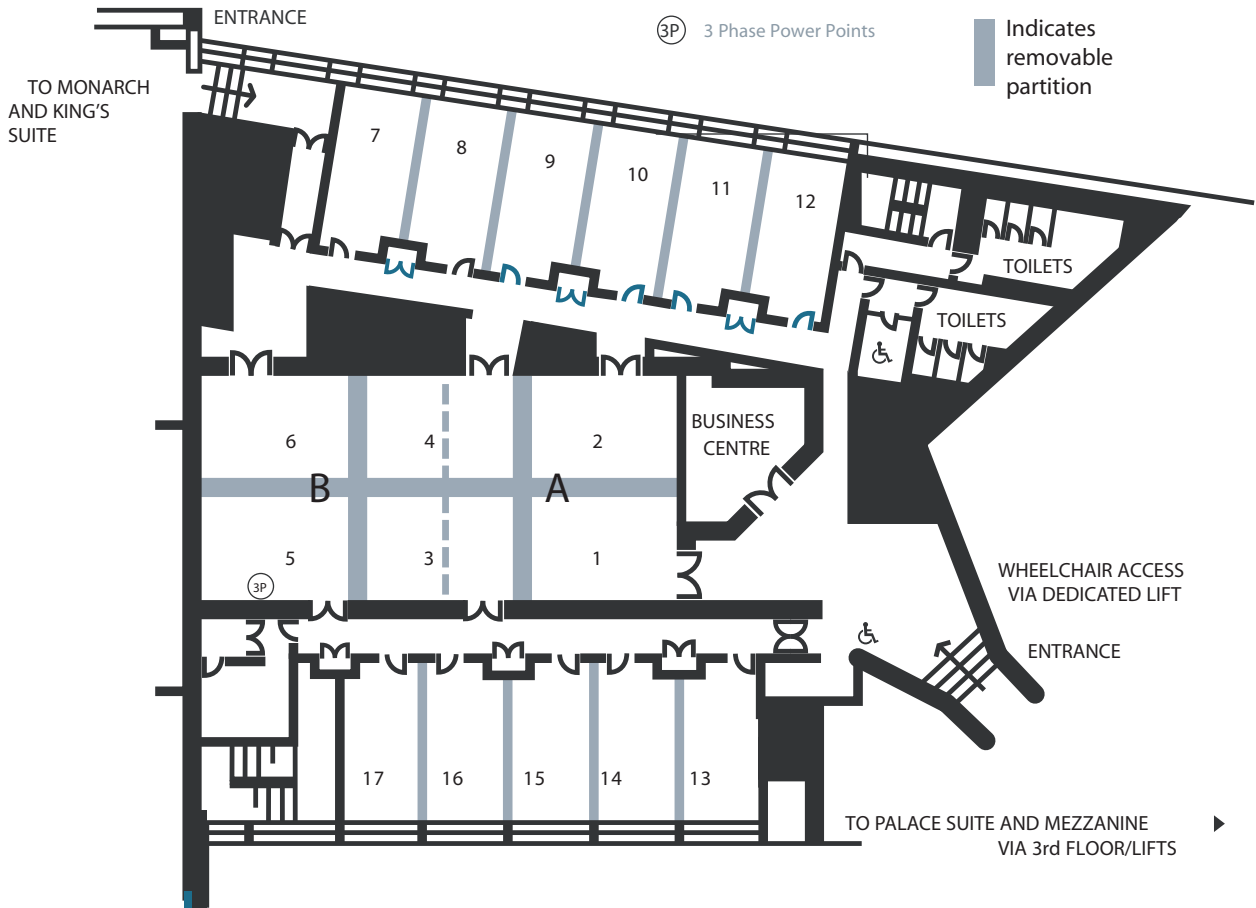



Meetings And Events

Hilton Meeting Room 7

We've complemented our major suites with 17 high-quality, smaller Hilton Meetings Rooms. Whether you want to run workshops, brainstorming, committee meetings, slide previews, VIP hospitality or any other activity, the Hilton Meetings promise is your guarantee of a successful, productive and hassle-free meeting.

Overview

Maximum capacity: 20

Dimensions

6.7m x 3.4m x 2.9m
21.98ft x 11.15ft x 9.51ft

Access size

2.4m x 0.9m / 7.87ft x 2.95ft (WxH)

Area

21.5m²
231.34m²

Lighting

Dimmer lighting, halogen downlighters, natural daylight and blackout facilities.

Located on

Tower Wing - 3rd Floor

Optional equipment

Wireless Internet Access



Layout and number of people



Theatre - 20



Boardroom - 12



Meetings And Events

Hilton Meeting Room 10

We've complemented our major suites with 17 high-quality, smaller Hilton Meetings Rooms. Whether you want to run workshops, brainstorming, committee meetings, slide previews, VIP hospitality or any other activity, the Hilton Meetings promise is your guarantee of a successful, productive and hassle-free meeting.

Overview

Maximum capacity: 20

Dimensions

6.7m x 3.4m x 2.9m
21.98ft x 11.15ft x 9.51ft

Access size

2.4m x 0.9m / 7.87ft x 2.95ft (WxH)

Area

20.6m²
221.66m²

Lighting

Dimmer lighting, halogen downlighters and blackout facilities.

Located on

Tower Wing - 3rd Floor

Optional equipment

Wireless Internet Access



Layout and number of people



Theatre - 20



Boardroom - 12



Meetings And Events

Hilton Meeting Rooms 7+8 / 9+10 / 11+12

We've complemented our major suites with 17 high-quality, smaller Hilton Meetings Rooms. Whether you want to run workshops, brainstorming, committee meetings, slide previews, VIP hospitality or any other activity, the Hilton Meetings promise is your guarantee of a successful, productive and hassle-free meeting.

Overview

Maximum capacity: 25

Dimensions

6.8m x 6.7m x 2.9m
22.31ft x 21.98ft x 9.51ft

Access size

2.4m x 0.9m / 7.87ft x 2.95ft (WxH)

Area

42.3m²
455.15m²

Lighting

Dimmer lighting, halogen downlighters, natural daylight and blackout facilities.

Located on

Tower Wing - 3rd Floor

Optional equipment

Wireless Internet Access



Layout and number of people



Classroom - 12



U-Shape - 10



Theatre - 25



Boardroom - 18



Meetings And Events

Hilton Meeting Room 15

We've complemented our major suites with 17 high-quality, smaller Hilton Meetings Rooms. Whether you want to run workshops, brainstorming, committee meetings, slide previews, VIP hospitality or any other activity, the Hilton Meetings promise is your guarantee of a successful, productive and hassle-free meeting.

Overview

Maximum capacity: 20

Dimensions

6.7m x 3.4m x 2.9m
21.98ft x 11.15ft x 9.51ft

Access size

2.4m x 0.9m / 7.87ft x 2.95ft (WxH)

Area

21.2m²
228.11m²

Lighting

Dimmer lighting, halogen downlighters and blackout facilities.

Located on

Tower Wing - 3rd Floor

Optional equipment

Wireless Internet Access



Layout and number of people



Theatre - 20



Boardroom - 12



Meetings And Events

Hilton Meeting Room 2

We've complemented our major suites with 17 high-quality, smaller Hilton Meetings Rooms. Whether you want to run workshops, brainstorming, committee meetings, slide previews, VIP hospitality or any other activity, the Hilton Meetings promise is your guarantee of a successful, productive and hassle-free meeting.

Overview

Maximum capacity: 25

Dimensions

6.3m x 4.7m x 3.1m
20.67ft x 15.42ft x 10.17ft

Access size

2.0m x 1.4m / 6.56ft x 4.59ft (WxH)

Area

30.0m²
322.8m²

Lighting

Dimmer lighting, halogen downlighters and blackout facilities.

Located on

Tower Wing - 3rd Floor

Optional equipment

Wireless Internet Access



Layout and number of people

 Classroom - 15

 U-Shape - 12

 Theatre - 25

 Boardroom - 16



Meetings And Events

Hilton Meeting Room 5

We've complemented our major suites with 17 high-quality, smaller Hilton Meetings Rooms. Whether you want to run workshops, brainstorming, committee meetings, slide previews, VIP hospitality or any other activity, the Hilton Meetings promise is your guarantee of a successful, productive and hassle-free meeting.

Overview

Maximum capacity: 25

Dimensions

6.4m x 4.7m x 3.1m
21.0ft x 15.42ft x 10.17ft

Access size

2.0m x 1.3m / 6.56ft x 4.27ft (WxH)

Area

30.0m²
322.8m²

Lighting

Dimmer lighting, halogen downlighters and blackout facilities.

Located on

Tower Wing - 3rd Floor

Optional equipment

Wireless Internet Access



Layout and number of people

 Classroom - 15

 U-Shape - 12

 Theatre - 25

 Boardroom - 16



Meetings And Events

Hilton Meeting Room 14

We've complemented our major suites with 17 high-quality, smaller Hilton Meetings Rooms. Whether you want to run workshops, brainstorming, committee meetings, slide previews, VIP hospitality or any other activity, the Hilton Meetings promise is your guarantee of a successful, productive and hassle-free meeting.

Overview

Maximum capacity: 20

Dimensions

6.7m x 3.4m x 2.9m
21.98ft x 11.15ft x 9.51ft

Access size

2.4m x 0.9m / 7.87ft x 2.95ft (WxH)

Area

20.6m²
221.66m²

Lighting

Dimmer lighting, halogen downlighters and blackout facilities.

Located on

Tower Wing - 3rd Floor

Optional equipment

Wireless Internet Access



Layout and number of people



Theatre - 20



Boardroom - 12



Meetings And Events

Hilton meeting Room 17

We've complemented our major suites with 17 high-quality, smaller Hilton Meetings Rooms. Whether you want to run workshops, brainstorming, committee meetings, slide previews, VIP hospitality or any other activity, the Hilton Meetings promise is your guarantee of a successful, productive and hassle-free meeting.

Overview

Maximum capacity: 20

Dimensions

6.7m x 3.4m x 2.9m
21.98ft x 11.15ft x 9.51ft

Access size

2.4m x 0.9m / 7.87ft x 2.95ft (WxH)

Area

14.8m²
159.25m²

Lighting

Dimmer lighting, halogen downlighters, natural daylight and blackout facilities.

Located on

Tower Wing - 3rd Floor

Optional equipment

Wireless Internet Access



Layout and number of people

 Theatre - 20

 Boardroom - 12



Meetings And Events

Hilton Meeting Rooms 13+14 / 15+16 / 16+17

We've complemented our major suites with 17 high-quality, smaller Hilton Meetings Rooms. Whether you want to run workshops, brainstorming, committee meetings, slide previews, VIP hospitality or any other activity, the Hilton Meetings promise is your guarantee of a successful, productive and hassle-free meeting.

Overview

Maximum capacity: 25

Dimensions

6.8m x 6.7m x 2.9m
22.31ft x 21.98ft x 9.51ft

Access size

2.4m x 0.9m / 7.87ft x 2.95ft (WxH)

Area

42.3m²
455.15m²

Lighting

Dimmer lighting, halogen downlighters, natural daylight and blackout facilities.

Located on

Tower Wing - 3rd Floor

Optional equipment

Wireless Internet Access



Layout and number of people

 Classroom - 12

 U-Shape - 10

 Theatre - 25

 Boardroom - 18



Meetings And Events

Hilton Meeting Room 8

We've complemented our major suites with 17 high-quality, smaller Hilton Meetings Rooms. Whether you want to run workshops, brainstorming, committee meetings, slide previews, VIP hospitality or any other activity, the Hilton Meetings promise is your guarantee of a successful, productive and hassle-free meeting.

Overview

Maximum capacity: 20

Dimensions

6.7m x 3.4m x 2.9m
21.98ft x 11.15ft x 9.51ft

Access size

2.4m x 0.9m / 7.87ft x 2.95ft (WxH)

Area

22.1m²
237.8m²

Lighting

Dimmer lighting, halogen downlighters, natural daylight and blackout facilities.

Located on

Tower Wing - 3rd Floor

Optional equipment

Wireless Internet Access



Layout and number of people



Theatre - 20



Boardroom - 12



Meetings And Events

Hilton Meeting Rooms 1+2 / 3+4 / 5+6

We've complemented our major suites with 17 high-quality, smaller Hilton Meetings Rooms. Whether you want to run workshops, brainstorming, committee meetings, slide previews, VIP hospitality or any other activity, the Hilton Meetings promise is your guarantee of a successful, productive and hassle-free meeting.

Overview

Maximum capacity: 50

Dimensions

9.8m x 6.4m x 3.1m
32.15ft x 21.0ft x 10.17ft

Area

61.7m²
663.89m²

Lighting

Dimmer lighting, halogen downlighters, natural daylight and blackout facilities.

Located on





Tower Wing - 3rd Floor

Optional equipment

Wireless Internet Access



Layout and number of people

-  Classroom - 35
-  U-Shape - 30
-  Theatre - 50
-  Boardroom - 32



Meetings And Events

Hilton Meeting Room 3

We've complemented our major suites with 17 high-quality, smaller Hilton Meetings Rooms. Whether you want to run workshops, brainstorming, committee meetings, slide previews, VIP hospitality or any other activity, the Hilton Meetings promise is your guarantee of a successful, productive and hassle-free meeting.

Overview

Maximum capacity: 25

Dimensions

6.3m x 4.7m x 3.1m
20.67ft x 15.42ft x 10.17ft

Access size

2.0m x 1.6m / 6.56ft x 5.25ft (WxH)

Area

30.0m²
322.8m²

Lighting

Dimmer lighting, halogen downlighters and blackout facilities.

Located on

Tower Wing - 3rd Floor

Optional equipment

Wireless Internet Access



Layout and number of people

 Classroom - 15

 U-Shape - 12

 Theatre - 25

 Boardroom - 16



Meetings And Events

Hilton Meeting Rooms 7-9 / 10-12

We've complemented our major suites with 17 high-quality, smaller Hilton Meetings Rooms. Whether you want to run workshops, brainstorming, committee meetings, slide previews, VIP hospitality or any other activity, the Hilton Meetings promise is your guarantee of a successful, productive and hassle-free meeting.

Overview

Maximum capacity: 34

Dimensions

10.2m x 6.7m x 2.9m
33.46ft x 21.98ft x 9.51ft

Access size

2.4m x 0.9m / 7.87ft x 2.95ft (WxH)

Area

62.7m²
674.65m²

Lighting

Dimmer lighting, halogen downlighters, natural daylight and blackout facilities.

Located on

Tower Wing - 3rd Floor

Optional equipment

Wireless Internet Access



Layout and number of people

 Classroom - 16

 U-Shape - 12

 Theatre - 34

 Boardroom - 24



Meetings And Events

Hilton Meeting Room 11

We've complemented our major suites with 17 high-quality, smaller Hilton Meetings Rooms. Whether you want to run workshops, brainstorming, committee meetings, slide previews, VIP hospitality or any other activity, the Hilton Meetings promise is your guarantee of a successful, productive and hassle-free meeting.

Overview

Maximum capacity: 20

Dimensions

6.7m x 3.4m x 2.9m
21.98ft x 11.15ft x 9.51ft

Access size

2.4m x 0.9m / 7.87ft x 2.95ft (WxH)

Area

21.2m²
228.11m²

Lighting

Dimmer lighting, halogen downlighters and blackout facilities.

Located on

Tower Wing - 3rd Floor

Optional equipment

Wireless Internet Access



Layout and number of people

 Theatre - 20

 Boardroom - 12



Meetings And Events

Hilton meeting Room 4

We've complemented our major suites with 17 high-quality, smaller Hilton Meetings Rooms. Whether you want to run workshops, brainstorming, committee meetings, slide previews, VIP hospitality or any other activity, the Hilton Meetings promise is your guarantee of a successful, productive and hassle-free meeting.

Overview

Maximum capacity: 25

Dimensions

6.3m x 4.7m x 3.1m
20.67ft x 15.42ft x 10.17ft

Access size

2.0m x 1.3m / 6.56ft x 4.27ft (WxH)

Area

30.0m²
322.8m²

Lighting

Dimmer lighting, halogen downlighters and blackout facilities.

Located on

Tower Wing - 3rd Floor

Optional equipment

Wireless Internet Access



Layout and number of people

 Classroom - 15

 U-Shape - 12

 Theatre - 25

 Boardroom - 16



Meetings And Events

Hilton Meeting Rooms 13 to 17

We've complemented our major suites with 17 high-quality, smaller Hilton Meetings Rooms. Whether you want to run workshops, brainstorming, committee meetings, slide previews, VIP hospitality or any other activity, the Hilton Meetings promise is your guarantee of a successful, productive and hassle-free meeting. These rooms can be used separately or linked together in a wide range of configurations.

Overview

Maximum capacity: 80

Dimensions

18.8m x 6.7m x 2.9m
61.68ft x 21.98ft x 9.51ft

Access size

2.4m x 0.9m / 7.87ft x 2.95ft (WxH)

Area

101.1m²
1087.84m²

Lighting

Dimmer lighting, halogen downlighters and blackout facilities.

Located on

Tower Wing - 3rd Floor

Optional equipment

Back Projection
Flip Charts
LCD
Microphone
Overhead Projector
Podium
Projector
Screen
Slide Projector
TV
Video Player



Layout and number of people



Classroom - 40



Theatre - 60



Meetings And Events

Hilton Meeting Room 16

We've complemented our major suites with 17 high-quality, smaller Hilton Meetings Rooms. Whether you want to run workshops, brainstorming, committee meetings, slide previews, VIP hospitality or any other activity, the Hilton Meetings promise is your guarantee of a successful, productive and hassle-free meeting.

Overview

Maximum capacity: 20

Dimensions

6.7m x 3.4m x 2.9m
21.98ft x 11.15ft x 9.51ft

Access size

2.4m x 0.9m / 7.87ft x 2.95ft (WxH)

Area

14.8m²
159.25m²

Lighting

Dimmer lighting, halogen downlighters and blackout facilities.

Located on

Tower Wing - 3rd Floor

Optional equipment

Wireless Internet Access



Layout and number of people

 Theatre - 20

 Boardroom - 12



Meetings And Events

Hilton Meeting Room 9

We've complemented our major suites with 17 high-quality, smaller Hilton Meetings Rooms. Whether you want to run workshops, brainstorming, committee meetings, slide previews, VIP hospitality or any other activity, the Hilton Meetings promise is your guarantee of a successful, productive and hassle-free meeting.

Overview

Maximum capacity: 20

Dimensions

6.7m x 3.4m x 2.9m
21.98ft x 11.15ft x 9.51ft

Access size

2.4m x 0.9m / 7.87ft x 2.95ft (WxH)

Area

21.2m²
228.11m²

Lighting

Dimmer lighting, halogen downlighters and blackout facilities.

Located on

Tower Wing - 3rd Floor

Optional equipment

Wireless Internet Access



Layout and number of people

 Theatre - 20

 Boardroom - 12



Meetings And Events

Hilton Meeting Room 1

We've complemented our major suites with 17 high-quality, smaller Hilton Meetings Rooms. Whether you want to run workshops, brainstorming, committee meetings, slide previews, VIP hospitality or any other activity, the Hilton Meetings promise is your guarantee of a successful, productive and hassle-free meeting.

Overview

Maximum capacity: 25

Dimensions

6.3m x 4.7m x 3.1m
20.67ft x 15.42ft x 10.17ft

Access size

2.0m x 1.4m / 6.56ft x 4.59ft (WxH)

Area

30.0m²
322.8m²

Lighting

Dimmer lighting, halogen downlighters and blackout facilities.

Located on

Tower Wing - 3rd Floor

Optional equipment

Wireless Internet Access



Layout and number of people



Classroom - 15



U-Shape - 12



Theatre - 25



Boardroom - 16



Meetings And Events

Hilton Meetings Rooms 1 to 6

We've complemented our major suites with 17 high-quality, smaller Hilton Meetings Rooms. Whether you want to run workshops, brainstorming, committee meetings, slide previews, VIP hospitality or any other activity, the Hilton Meetings promise is your guarantee of a successful, productive and hassle-free meeting.

Overview

Maximum capacity: 200

Dimensions

19.3m x 9.8m x 3.1m
63.32ft x 32.15ft x 10.17ft

Access size

2.0m x 1.6m / 6.56ft x 5.25ft (WxH)

Area

188.0m²
2022.88m²

Lighting

Dimmer lighting, halogen downlighters and blackout facilities.

Located on

Tower Wing - 3rd Floor

Optional equipment

Back Projection
Flip Charts
LCD
Microphone
Overhead Projector
Podium
Projector
Screen
Slide Projector
TV
Video Player
Wireless Internet Access



Layout and number of people



Classroom - 120



U-Shape - 50



Theatre - 200



Meetings And Events

Monarch Suite

The Monarch is a versatile, multi purpose suite with high-tec lighting systems which makes the room particularly suited to extravagant banqueting events and award dinners. This spectacular room is able to project sponsor logos and pin-spotlights on individual tables which changes the mood and atmosphere instantly with sensational colour washes or computer generated waves of light.

Overview

Maximum capacity: 1600

Dimensions

54.0m x 23.7m x 4.48m
177.17ft x 77.76ft x 14.7ft

Access size

2.0m x 2.1m / 6.56ft x 6.89ft (WxH)

Area

1062.0m²
11427.12m²

Lighting

This spectacular room is able to project sponsor logos and pin-spotlights on individual tables with sensational colour washes or computer generated waves of light. Halogan downlighters and coloured LED light settings are available.

Located on

West Wing - 1st Floor

Optional equipment

- Back Projection
- Flip Charts
- Karaoke
- LCD
- Microphone
- Overhead Projector
- Podium
- Projector
- Screen
- Slide Projector
- TV
- Video Player

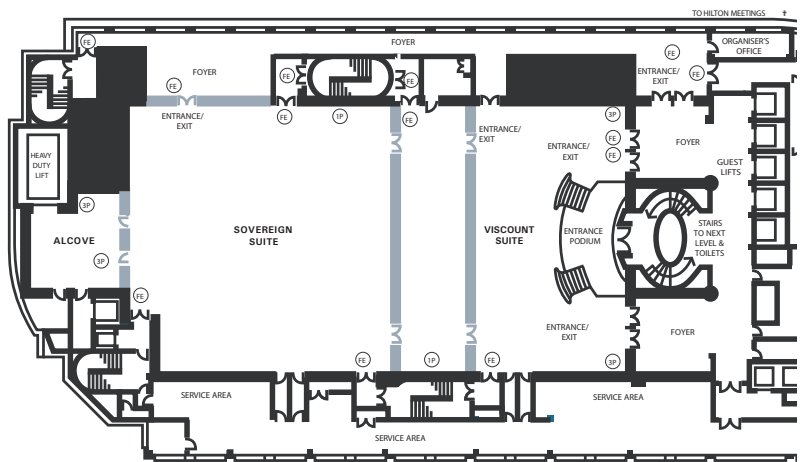

Layout and number of people



Classroom - 600



Theatre - 1600



Banquet - 1000



Meetings And Events

Hilton Meetings Rooms 7 to 12

We've complemented our major suites with 17 high-quality, smaller Hilton Meetings Rooms. Whether you want to run workshops, brainstorming, committee meetings, slide previews, VIP hospitality or any other activity, the Hilton Meetings promise is your guarantee of a successful, productive and hassle-free meeting. These rooms can be used separately or linked together in a wide range of configurations.

Overview

Maximum capacity: 80

Dimensions

20.4m x 6.7m x 2.9m
66.93ft x 21.98ft x 9.51ft

Access size

2.4m x 0.9m / 7.87ft x 2.95ft (WxH)

Area

126.0m²
1355.76m²

Lighting

Halogen downlighters and natural daylight.

Located on

West Wing - 3rd Floor

Optional equipment

Back Projection
Flip Charts
LCD
Microphone
Overhead Projector
Projector
Screen
Wireless Internet Access



Layout and number of people



Classroom - 60



Theatre - 80



Meetings And Events

King's Suite

The King's Suite is London's finest and largest conference spaces with capacity for 1,700 delegates. It divides easily to hold parallel meetings for up to 700 and 450 or 900 and 220. It also offers back projection, high-tech lighting and room for 50 exhibition stands of 3 x 3 metres.

Overview

Maximum capacity: 1600

Dimensions

54.0m x 23.7m x 4.48m
 177.17ft x 77.76ft x 14.7ft

Access size

2.0m x 2.1m / 6.56ft x 6.89ft (WxH)

Area

1062.0m²
 11427.12m²

Lighting

Dimmer lighting and blackout facilities. Also included is state of the art lighting technology with coloured pinspots and 15 main ceiling coffers.

Located on

West Wing - 3rd Floor

Optional equipment

- Back Projection
- Flip Charts
- Karaoke
- LCD
- Microphone
- Overhead Projector
- Podium
- Projector
- Screen
- Slide Projector
- TV
- Video Player

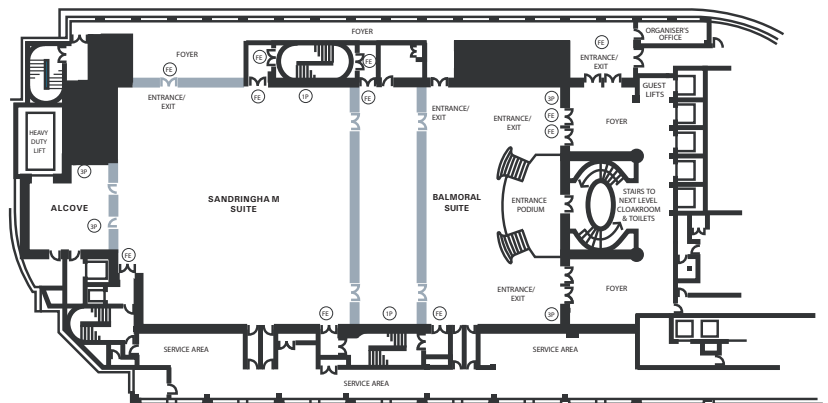

Layout and number of people



Classroom - 650



Theatre - 1600



Banquet - 1000



Meetings And Events

Leisure Facilities



Journey's Friend gift shop

The Hilton London Metropole hotel makes gift shopping easy. Surprise the kids back home with a toy Paddington Bear or stock up on toiletries.



Health and fitness

Maintain your fitness regime at the Hilton London Metropole hotel's gym and pool. Soothe tired muscles afterwards in the sauna.



LivingWell Health Club

Exercise away from home at the Hilton London Metropole hotel's fully equipped gym. The pool and sauna are good places to relax after a long meeting.



Executive Lounge

Business is a pleasure at the Hilton London Metropole hotel's Executive Lounge. Enjoy a free continental breakfast or debrief over drinks.



London attractions

Want to know when the food hall at Harrods shuts? Let the Hilton London Metropole hotel's Concierge team answer your queries on London attractions.

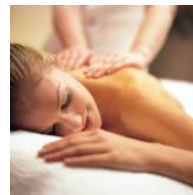

Contrasti Hair and Beauty

Feel like treating yourself? The Hilton London Metropole hotel's salon is the perfect spot for a little indulgence, be it a new haircut or a massage.